



DAS/IBS Componentes

Catálogo



Attenuator 200W (698-3800)

Model: PVL106.400638

Product Features:

- Low VSWR
- Low PIM
- High reliability



Technical Specifications:

Electrical										
Attenuation	3	5	7	10	15	20	25	30	35	40
Attenuation accuracy	±0.6			±0.8				±1.0		
Frequency (MHz)	698-3800									
VSWR	≤1.25									
PIM, 3rd Order (dBc)	≤ -160 (2 x 43 dBm carrier)									
Average power, maximum (W)	200									
Impedance (Ω)	50									
Grounding	DC Ground									

Mechanical	
Operating temperature	-20°C to +60°C
Storage temperature	-35°C to +75°C
Relative humidity	5% - 95%
Classification of waterproof	IP67
Dimensions (H x W x D) (mm)	200x198x82mm
Net weight (with installation kit) (kg)	≤4.5
Connector	N-Female/Din-Female/4.3-10 Female

Schematic Diagram

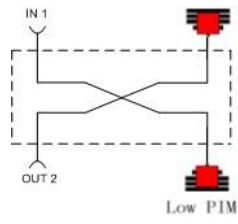

Outline Drawing:

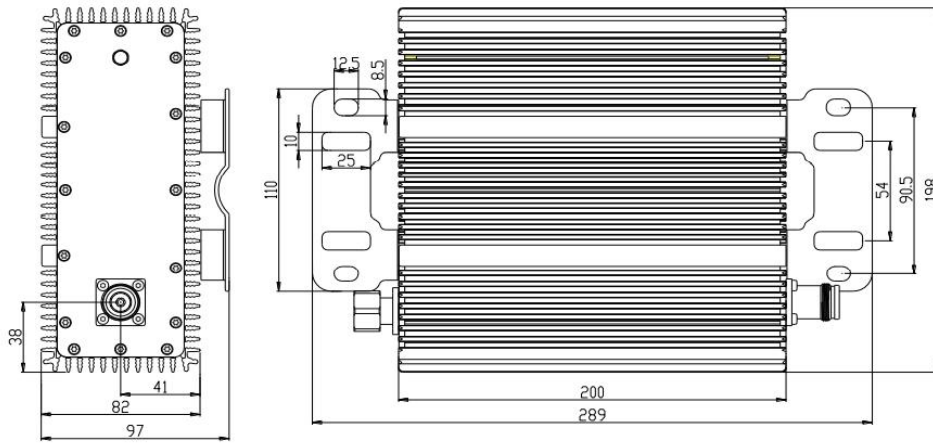

Attenuator 100W (698-2700)

Model: PVL106.400627

Product Features:

- Low VSWR
- Low PIM
- High reliability



Technical Specifications:

Electrical										
Attenuation	3	5	7	10	15	20	25	30	35	40
Attenuation accuracy	±0.6			±0.8			±1.0			
Frequency (MHz)	698-2700									
VSWR	≤1.25									
PIM, 3rd Order (dBc)	≤ -160 (2 x 43 dBm carrier)									
Average power, maximum (W)	80									
Impedance (Ω)	50									
Grounding	DC Ground									

Mechanical	
Operating temperature	-20°C to +60°C
Storage temperature	-35°C to +75°C
Relative humidity	5% - 95%
Classification of waterproof	IP67
Dimensions (H x W x D) (mm)	140x160x82mm
Net weight (with installation kit) (kg)	≤2.5
Connector	N-Female/Din-Female/4.3-10 Female

Schematic Diagram

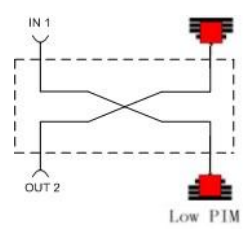

Outline Drawing:

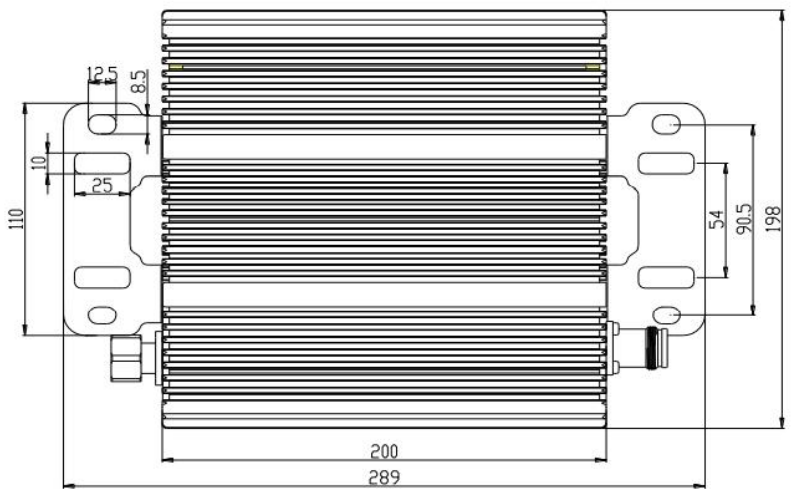
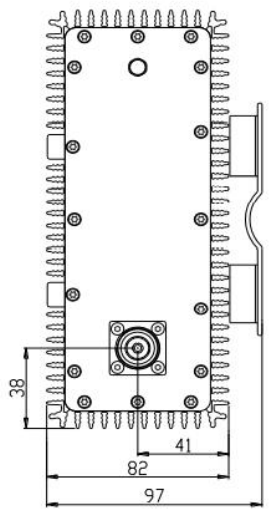

Termination Load 200W (DC-4000)

Model: PVL105.02000040

Product Features:

- Wide frequency range
- Low VSWR
- Low PIM
- High reliability



Technical Specifications:

Electrical	
Frequency (MHz)	DC-4000
Return loss/VSWR	$\leq -20\text{dB}/1.22$
PIM, 3rd Order (dBc)	≤ -160 (2 x 43 dBm carrier)
Average power, maximum (W)	200
Impedance (Ω)	50

Mechanical	
Operating temperature	-55°C to $+65^{\circ}\text{C}$
Storage temperature	-40°C to $+85^{\circ}\text{C}$
Relative humidity	5% - 95%
Classification of waterproof	IP67
Dimensions (H x W x D) (mm)	200x198x82mm
Net weight (with installation kit) (kg)	≤ 2.0
Connector	N-Female/Din-Female/4.3-10 Female

Schematic Diagram

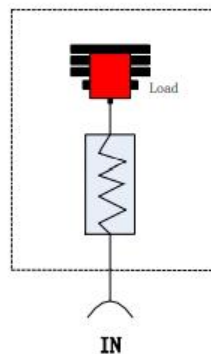

Outline Drawing:

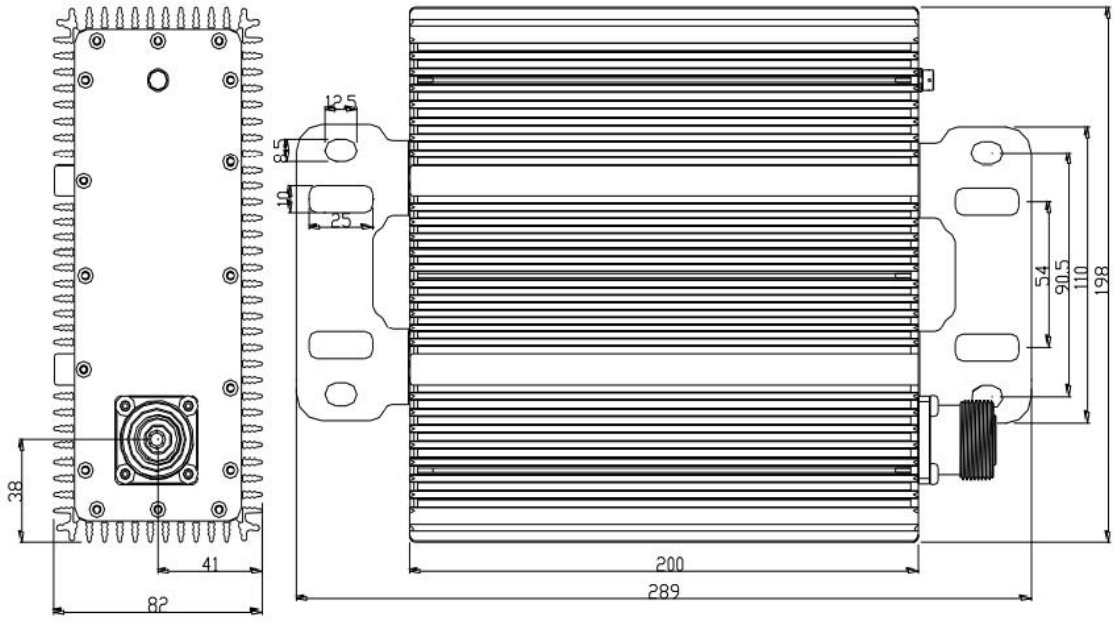

Termination Load 100W (DC-4000)

Model: PVL105.01000040

Product Features:

- Wide frequency range
- Low VSWR
- Low PIM
- High reliability



Technical Specifications:

Electrical	
Frequency (MHz)	DC-4000
Return loss/VSWR	$\leq -20\text{dB}/1.22$
PIM, 3rd Order (dBc)	≤ -160 (2 x 43 dBm carrier)
Average power, maximum (W)	100
Impedance (Ω)	50

Mechanical	
Operating temperature	-55°C to $+65^{\circ}\text{C}$
Storage temperature	-40°C to $+85^{\circ}\text{C}$
Relative humidity	5% - 95%
Classification of waterproof	IP67
Dimensions (H x W x D) (mm)	189x100x60mm
Net weight (with installation kit) (kg)	≤ 2.0
Connector	N-Female/Din-Female/4.3-10 Female

Schematic Diagram

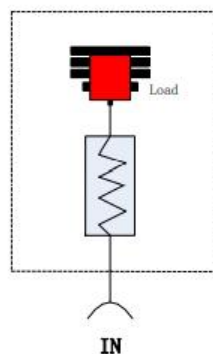

Outline Drawing:



Built-in Load 3dB Hybrid Coupler (700-6000)

Model: PVL103.030760

Product Features:

- 5G compatible
- Low insert loss
- Low PIM
- High reliability



Technical Specifications:

Electrical	
Frequency (MHz)	700-6000
Insert loss (dB)	≤ 0.1
Attenuation (dB)	$\leq 3.1 \pm 1.6$
Isolation (dB)	20
VSWR	≤ 1.35
PIM, 3rd Order (dBc)	≤ -160 (2 x 43 dBm carrier)
Average power, maximum (W)	200
Impedance (Ω)	50
DC/AISG	P1-P3 Bypass; P2-Short cut

Mechanical	
Operating temperature	-20°C to +60°C
Storage temperature	-35°C to +75°C
Relative humidity	5% - 95%
Classification of waterproof	IP66
Dimensions (H x W x D) (mm)	216x197x97.5mm
Net weight (with installation kit) (kg)	≤ 4.5
Connector	N-Female/Din-Female/4.3-10 Female

Directional Coupler (698-3800)

Model: PVL103.400638

Product Features:

- Low insert loss
- Low PIM
- High reliability



Technical Specifications:

Electrical										
Coupling level	5	6	7	10	15	20	25	30	35	40
Attenuation (dB)	±0.8	±0.8	±0.8	±1.0	±1.0	±1.0	±1.2	±1.2	±1.2	±1.2
Attenuation (dB) IN→P1	2.0	1.8	1.3	0.7	0.4	0.3	0.2	0.2	0.2	0.2
Isolation (dB)	25	26	27	30	35	40	45	50	55	60
Frequency (MHz)	698-3800									
VSWR	≤1.25									
PIM, 3rd Order (dBc)	≤ -160 (2 x 43 dBm carrier)									
Average power, maximum (W)	500									
Impedance (Ω)	50									

Mechanical	
Operating temperature	-20°C to +60°C
Storage temperature	-35°C to +75°C
Relative humidity	5% - 95%
Classification of waterproof	IP67
Dimensions (H x W x D) (mm)	169x63.4x32mm
Net weight (with installation kit) (kg)	≤0.75
Connector	N-Female/Din-Female/4.3-10 Female

Schematic Diagram

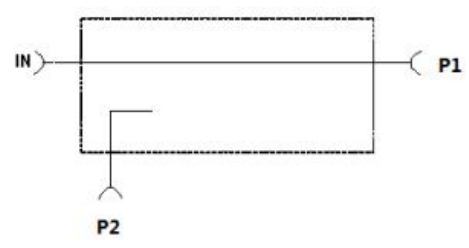

Outline Drawing:

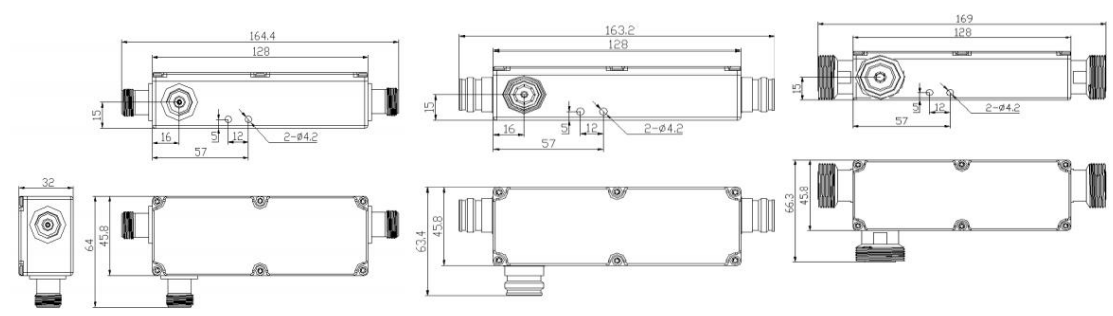

Directional Coupler (698-2700)

Model: PVL103.400627

Product Features:

- Low insert loss
- Low PIM
- High reliability



Technical Specifications:

Electrical										
Coupling level	5	6	7	10	15	20	25	30	35	40
Attenuation (dB)	±0.8	±0.8	±0.8	±1.0	±1.0	±1.0	±1.2	±1.2	±1.2	±1.2
Attenuation (dB) IN→P1	2.0	1.8	1.3	0.7	0.4	0.3	0.2	0.2	0.2	0.2
Isolation (dB)	25	26	27	30	35	40	45	50	55	60
Frequency (MHz)	698-2700									
VSWR	≤1.25									
PIM, 3rd Order (dBc)	≤ -160 (2 x 43 dBm carrier)									
Average power, maximum (W)	500									
Impedance (Ω)	50									

Mechanical	
Operating temperature	-20°C to +60°C
Storage temperature	-35°C to +75°C
Relative humidity	5% - 95%
Classification of waterproof	IP67
Dimensions (H x W x D) (mm)	169x63.4x32mm
Net weight (with installation kit) (kg)	≤0.75
Connector	N-Female/Din-Female/4.3-10 Female

Schematic Diagram

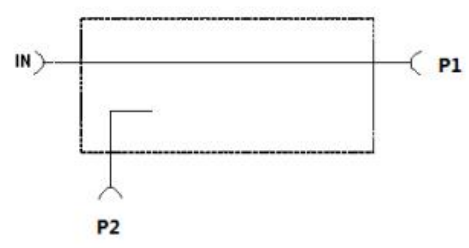

Outline Drawing:

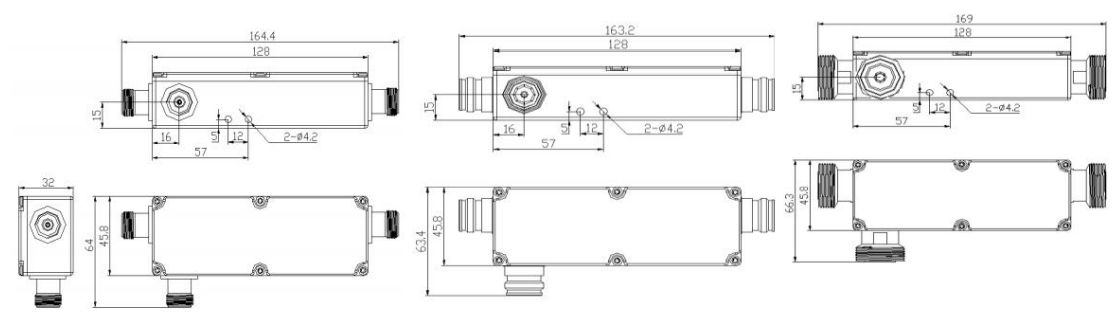

3dB Hybrid Coupler (698-6000)

Model: PVL104.02020660

Product Features:

- 5G compatible
- Excellent intermodulation performance
- High stability



Technical Specifications:

Electrical	
Frequency (MHz)	698-6000
Insertion Loss (dB)	≤3.1
Ripple in Band (dB)	≤1.6
Isolation (dB)	≥20
Return Loss/VSWR	≤-20dB/1.22
PIM, 3rd Order (dBc)	≤ -160 (2 x 43 dBm carrier)
Average power, maximum (W)	200
Impedance (Ω)	50
DC/AISG	By-pass(max.3000mA)
Lightning protection	10KA; 10/350μs pulse

Mechanical	
Operating temperature	-20°C to +65°C
Storage temperature	-40°C to +85°C
Relative humidity	5% - 95%
Classification of waterproof	IP67
Dimensions (H x W x D) (mm)	184x42x44mm
Net weight (with installation kit) (kg)	≤0.8
Connector	N-female/Din-Female/4.3-10 Female

Schematic Diagram

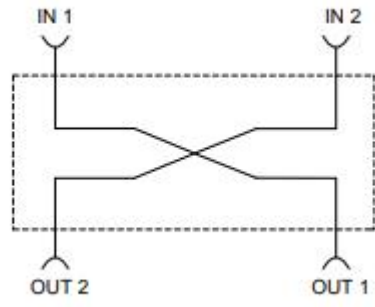

Outline Drawing:

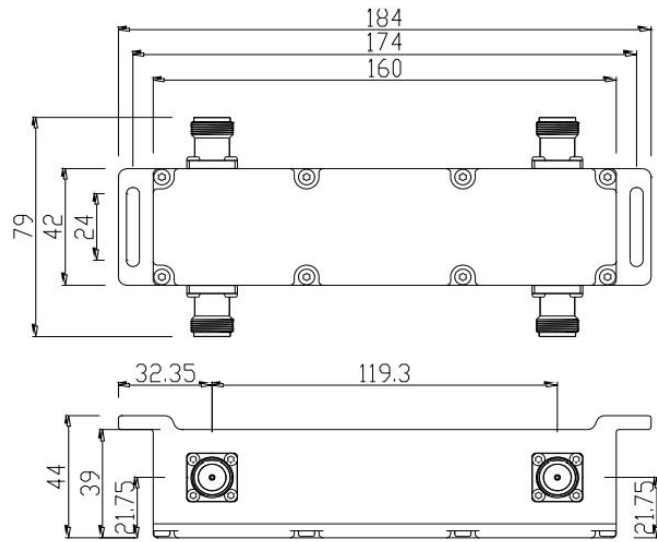

3dB Hybrid Coupler (550-2700)

Model: PVL104.02020527

Product Features:

- Low insertion loss
- Excellent intermodulation performance
- High stability
- High isolation



Technical Specifications:

Electrical	
Frequency (MHz)	550-2700
Insertion loss (dB)	≤3.8
Ripple in Band (dB)	≤1.0
Isolation (dB)	≥25
Return Loss/VSWR	≤-20dB/1.22
PIM, 3rd Order (dBc)	≤ -160 (2 x 43 dBm carrier)
Average power, maximum (W)	500
Impedance (Ω)	50
DC/AISG	By-pass(max.3000mA)
Lightning protection	10KA; 10/350μs pulse

Mechanical	
Operating temperature	-20°C to +65°C
Storage temperature	-40°C to +85°C
Relative humidity	5% - 95%
Classification of waterproof	IP67
Dimensions (H x W x D) (mm)	200x42x39.5mm
Net weight (with installation kit) (kg)	≤1.25
Connector	N-female/Din-Female/4.3-10 Female

Schematic Diagram

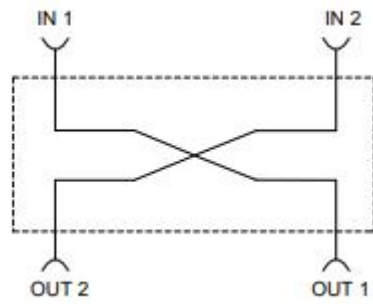

Outline Drawing:

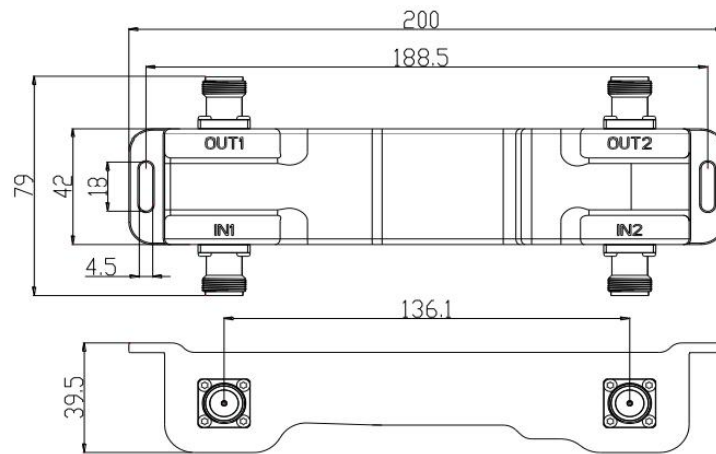

3dB Hybrid Coupler (698-2700)

Model: PVL104.02020627

Product Features:

- Low insertion loss
- Excellent intermodulation performance
- High stability
- High isolation



Technical Specifications:

Electrical	
Frequency (MHz)	698-2700
Attenuation in-out (dB)	≤3.5
Isolation (dB)	≥28
Return Loss/VSWR	≤-20dB/1.22
PIM, 3rd Order (dBc)	≤ -160 (2 x 43 dBm carrier)
Average power, maximum (W)	300
Impedance (Ω)	50
DC/AISG	By-pass(max.3000mA)
Lightning protection	10KA; 10/350μs pulse

Mechanical	
Operating temperature	-20°C to +65°C
Storage temperature	-40°C to +85°C
Relative humidity	5% - 95%
Classification of waterproof	IP67
Dimensions (H x W x D) (mm)	184x42x44mm
Net weight (with installation kit) (kg)	≤0.8
Connector	N-female/Din-Female/4.3-10 Female

Schematic Diagram

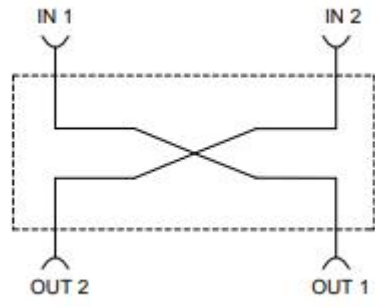

Outline Drawing:

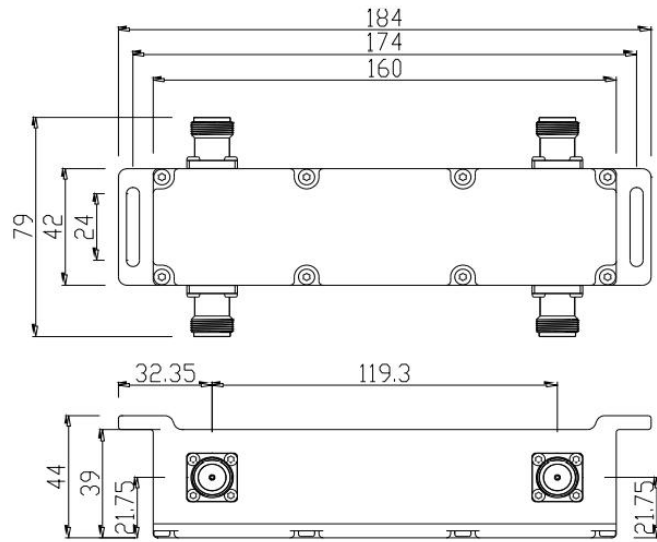

3x3 Matrix Hybrid Coupler (698-6000)

Model: PVL104.03030660

Product Features:

- Low insertion loss
- Ultra-low intermodulation
- High stability
- High isolation



Technical Specifications:

Electrical	
Frequency (MHz)	698-6000
Coupling & Variation (Contain insertion loss)	5.0 ± 2 .dB
Isolation (dB)	≥ 18
Return Loss/VSWR	≤ -20 dB/1.5
PIM, 3rd Order (dBc)	≤ -160 (2 x 43 dBm carrier)
Average power, maximum (W)	500
Impedance (Ω)	50
DC/AISG	DC path IN 1→OUT 3, IN 2→OUT 2 DC path IN 3→OUT 1 (max. 6.5 A AISG2.0 conform)

Mechanical	
Operating temperature	-20°C to +60°C
Storage temperature	-40°C to +85°C
Relative humidity	5% - 95%
Classification of waterproof	IP67
Dimensions (H x W x D) (mm)	194x100x55.2mm
Net weight (with installation kit) (kg)	≤ 1.8
Connector	N-female/Din-Female/4.3-10 Female

Schematic Diagram

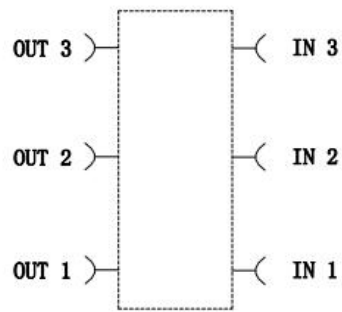

Outline Drawing:

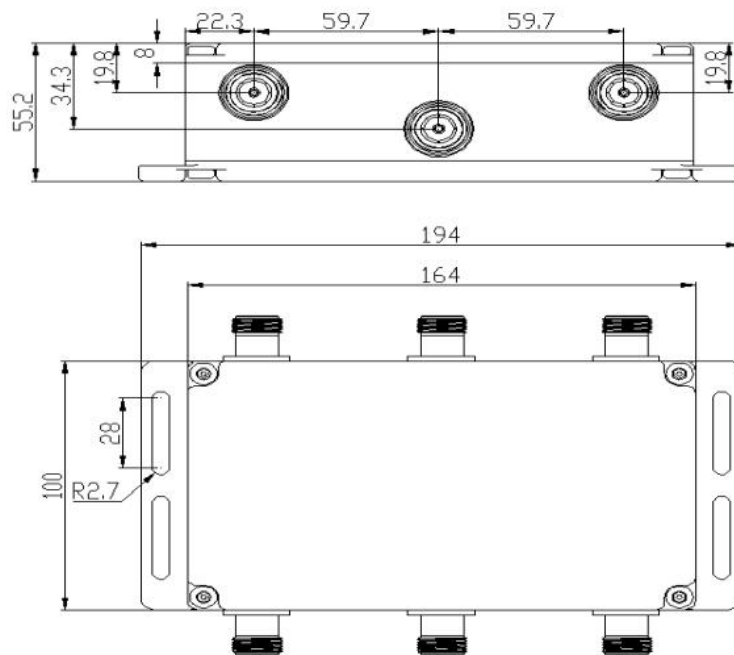

3x3 Matrix Hybrid Coupler (698-2700)

Model: PVL104.03030627

Product Features:

- Low insertion loss
- Ultra-low intermodulation
- High stability
- High isolation



Technical Specifications:

Electrical	
Frequency (MHz)	698-2700
Coupling & Variation (Contain insertion loss)	5.0±1.2dB 698-2700
Isolation (dB)	≥25
Return Loss/VSWR	≤ -20dB/1.25
PIM, 3rd Order (dBc)	≤ -155 (2 x 43 dBm carrier)
Average power, maximum (W)	500
Impedance (Ω)	50
DC/AISG	DC path IN 1→OUT 3, IN 2→OUT 2 DC path IN 3→OUT 1 (max. 6.5 A AISG2.0 conform)

Mechanical	
Operating temperature	-20°C to +60°C
Storage temperature	-40°C to +85°C
Relative humidity	5% - 95%
Classification of waterproof	IP67
Dimensions (H x W x D) (mm)	194x100x55.2mm
Net weight (with installation kit) (kg)	≤1.8
Connector	N-female/Din-Female/4.3-10 Female

Schematic Diagram

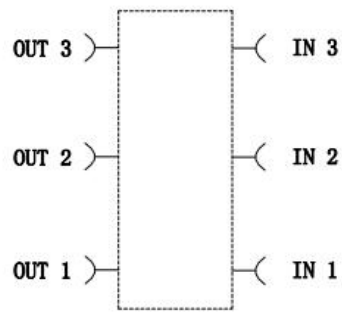

Outline Drawing:

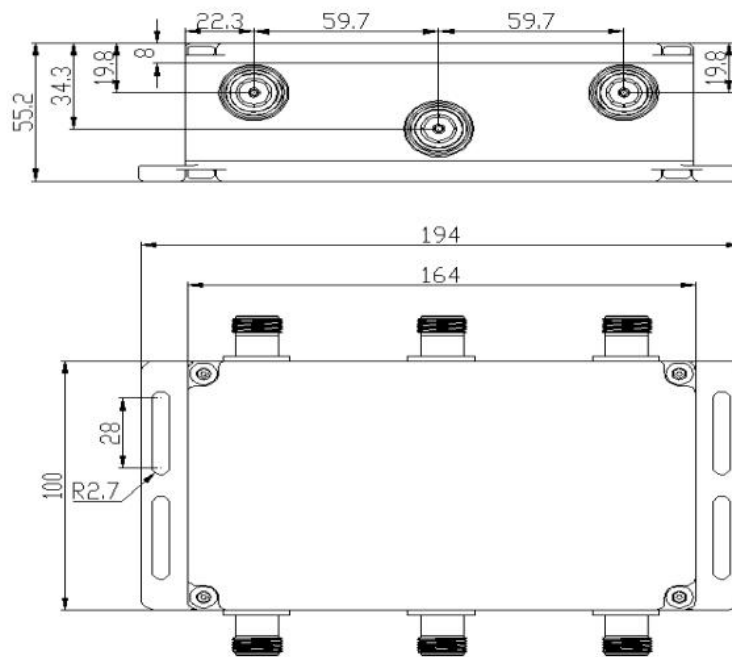

4x4 Matrix Hybrid Coupler (698-6000)

Model: PVL104.04040660

Product Features:

- 698-6000MHz
- Low insertion loss
- Ultra-low intermodulation
- High stability
- High isolation



Technical Specifications:

Electrical	
Frequency (MHz)	698-6000
Attenuation in-out (dB)	≤6.9
Isolation (dB)	≥18
Return Loss/VSWR	≤-20dB/1.5
PIM, 3rd Order (dBc)	≤ -160 (2 x 43 dBm carrier)
Average power, maximum (W)	200
Impedance (Ω)	50
DC/AISG	DC path IN 1→OUT 4, IN 2→OUT 2 DC path IN 3→OUT 3, IN 4→OUT 1 (max. 6.5 A AISG2.0 conform)
Lightning protection	N/A

Mechanical	
Operating temperature	-20°C to +65°C
Storage temperature	-40°C to +85°C
Relative humidity	5% - 95%
Classification of waterproof	IP67
Dimensions (H x W x D) (mm)	250x94x45mm
Net weight (with installation kit) (kg)	≤2.0
Connector	N-female/Din-Female/4.3-10 Female

Schematic Diagram

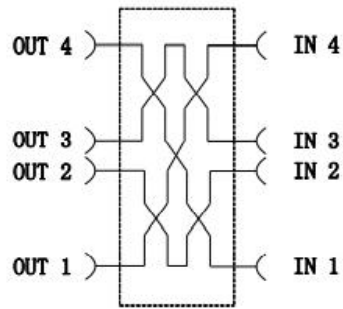

Outline Drawing:

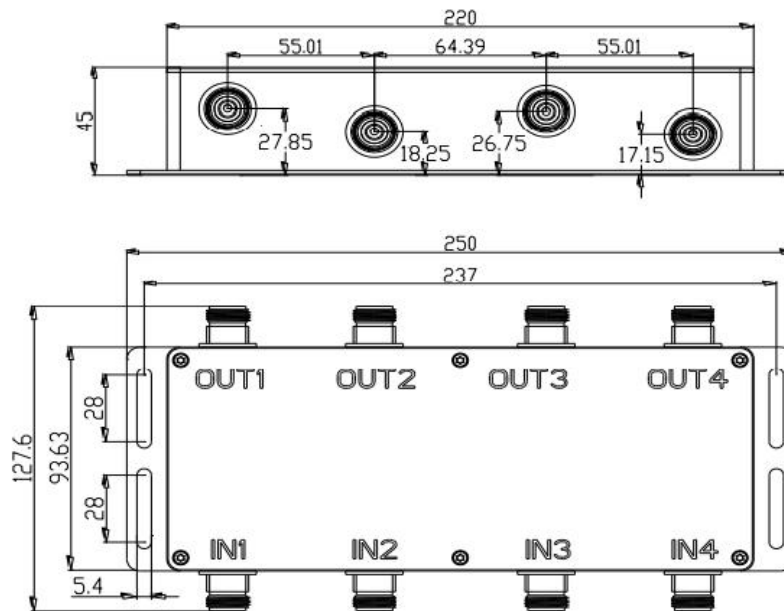

4x4 Matrix Hybrid Coupler (698-2700)

Model: PVL104.04040627

Product Features:

- 698-2700MHz
- Low insertion loss
- Ultra-low intermodulation
- High stability
- High isolation



Technical Specifications:

Electrical	
Frequency (MHz)	698-2700
Attenuation in-out (dB)	≤6.9
Isolation (dB)	≥26
Return Loss/VSWR	≤-20dB/1.22
PIM, 3rd Order (dBc)	≤ -160 (2 x 43 dBm carrier)
Average power, maximum (W)	300
Impedance (Ω)	50
DC/AISG	DC path IN 1→OUT 4, IN 2→OUT 2 DC path IN 3→OUT 3, IN 4→OUT 1 (max. 6.5 A AISG2.0 conform)
Lightning protection	N/A

Mechanical	
Operating temperature	-20°C to +65°C
Storage temperature	-40°C to +85°C
Relative humidity	5% - 95%
Classification of waterproof	IP67
Dimensions (H x W x D) (mm)	250x94x45mm
Net weight (with installation kit) (kg)	≤2.0
Connector	N-female/Din-Female/4.3-10 Female

Schematic Diagram

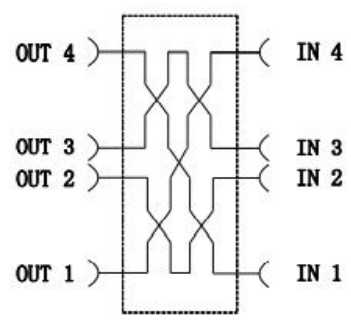

Outline Drawing:

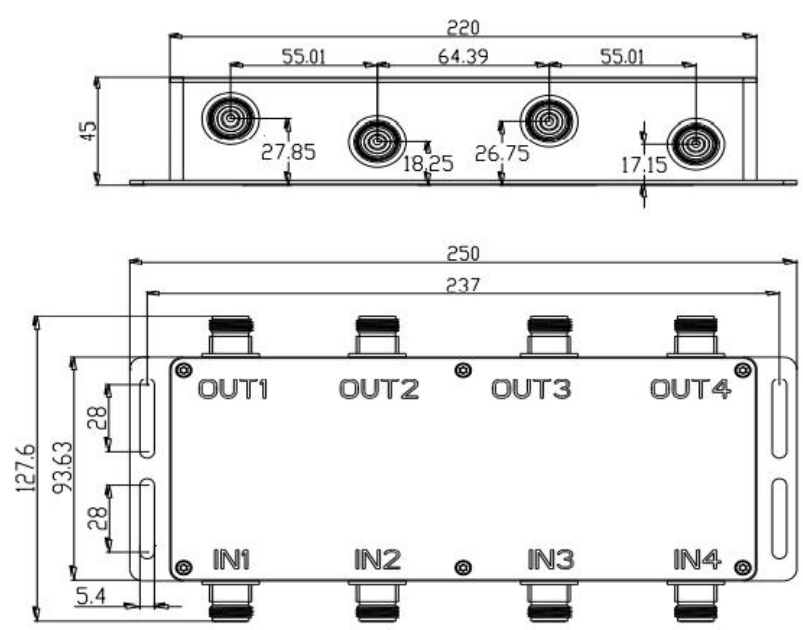

Indoor Diplexer Combiner (380-2500)

Model: PVL101.02010325

Product Features:

- Low Intermodulation
- High Isolation, Low VSWR and Loss
- Low Weight
- High Reliability



Technical Specifications:

Electrical		
Frequency (MHz)	380-960	1710-2500
Insertion Loss (dB)	≤0.3	
Ripple (dB)	≥0.2	
Isolation (dB)	≥80	
Return Loss/VSWR	≤18dB/1.22	
PIM, 3rd Order (dBc)	≤ -140 (2 x 43 dBm carrier)	
Average power, maximum (W)	200	
Impedance (Ω)	50	

Mechanical	
Operating temperature	-20°C to +65°C
Storage temperature	-40°C to +85°C
Relative humidity	5% - 95%
Classification of waterproof	Indoor
Dimensions (H x W x D) (mm)	148x73x29.5mm
Net weight (with installation kit) (kg)	≤0.52
Connector	N-Female

Schematic Diagram

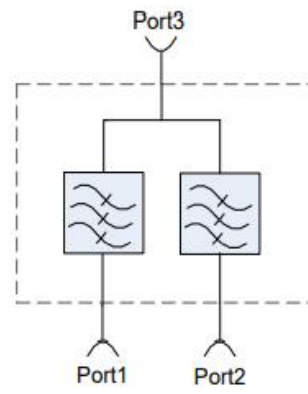

Outline Drawing:

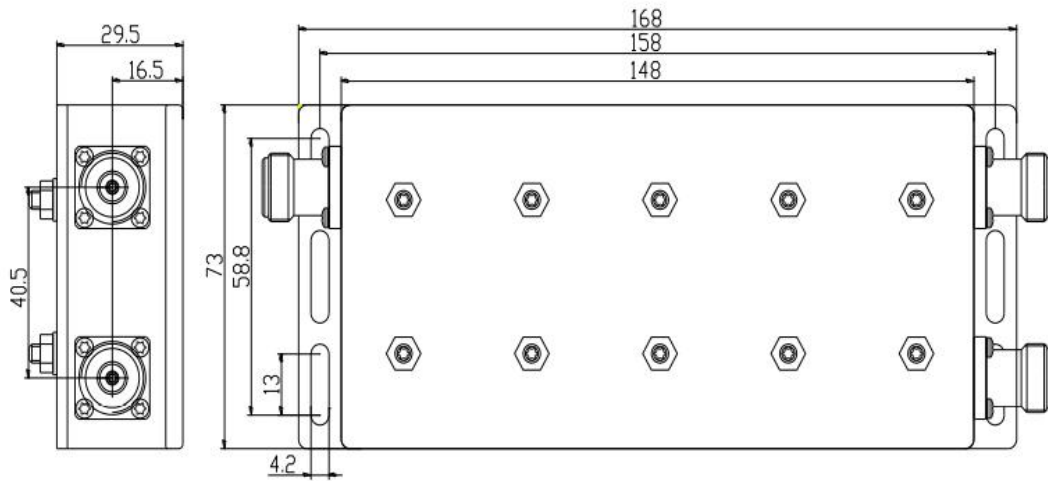

Indoor Diplexer Combiner (380-2700)

Model: PVL101.02010327

Product Features:

- Low Intermodulation
- High Isolation, Low VSWR and Loss
- Low Weight
- High Reliability



Technical Specifications:

Electrical		
Frequency (MHz)	380-2200	2400-2700
Insertion Loss (dB)	≤0.4	≤0.5
Ripple (dB)	≥0.4	
Isolation (dB)	≥80	
Return Loss/VSWR	≤19dB/1.22	
PIM, 3rd Order (dBc)	≤ -140 (2 x 43 dBm carrier)	
Average power, maximum (W)	200	
Impedance (Ω)	50	

Mechanical	
Operating temperature	-20°C to +65°C
Storage temperature	-40°C to +85°C
Relative humidity	5% - 95%
Classification of waterproof	Indoor
Dimensions (H x W x D) (mm)	119x104x28mm
Net weight (with installation kit) (kg)	≤0.6
Connector	N-Female

Schematic Diagram

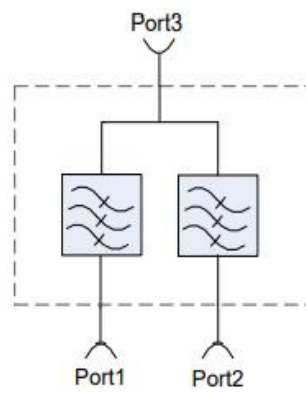

Outline Drawing:

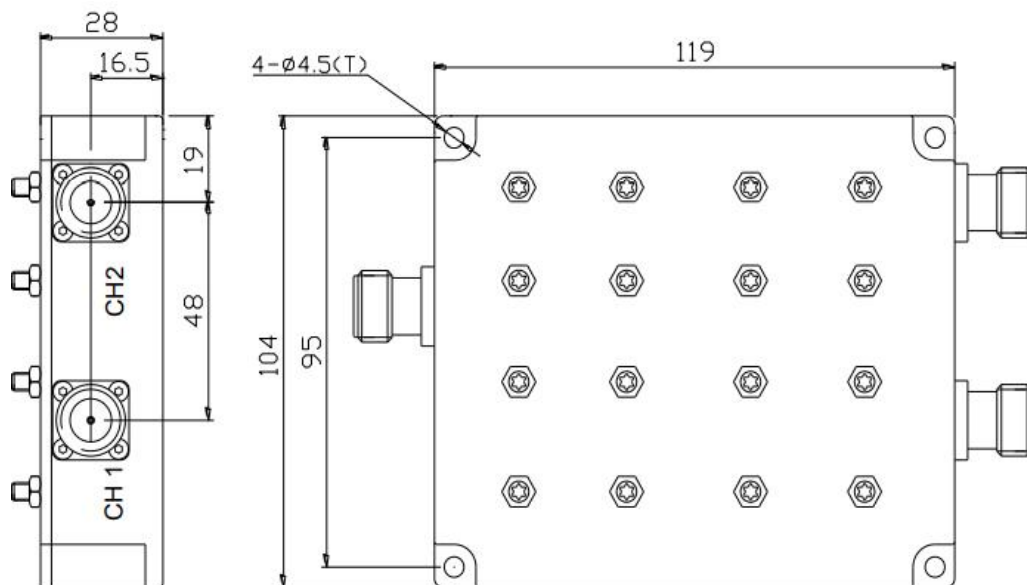

Indoor Diplexer Combiner (1710-2170)

Model: PVL101.02011721

Product Features:

- Low Intermodulation
- High Isolation, Low VSWR and Loss
- Low Weight
- High Reliability



Technical Specifications:

Electrical		
Frequency (MHz)	1710-1880	1920-2170
Insertion Loss (dB)	≤0.6	
Ripple (dB)	≥0.5	
Isolation (dB)	≥80	
Return Loss/VSWR	≤18dB/1.22	
PIM, 3rd Order (dBc)	≤ -145 (2 x 43 dBm carrier)	
Average power, maximum (W)	200	
Impedance (Ω)	50	

Mechanical	
Operating temperature	-20°C to +65°C
Storage temperature	-40°C to +85°C
Relative humidity	5% - 95%
Classification of waterproof	Indoor
Dimensions (H x W x D) (mm)	120x98x35.5mm
Net weight (with installation kit) (kg)	≤0.6
Connector	N-Female

Schematic Diagram

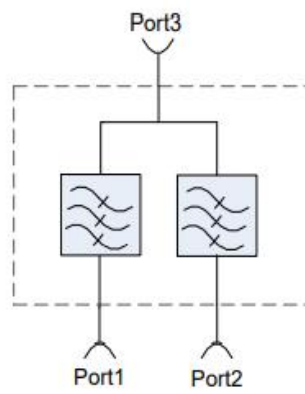

Outline Drawing:

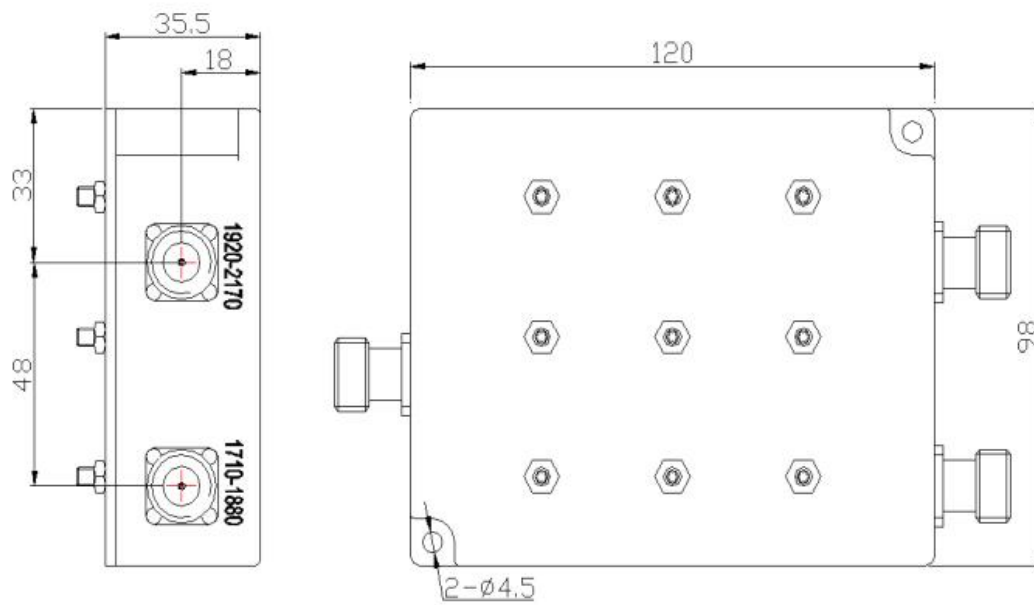

Indoor Triplexer Combiner (698-2700)

Model: PVL101.03010627

Product Features:

- Low Intermodulation
- High Isolation, Low VSWR and Loss
- Low Weight
- High Reliability



Technical Specifications:

Electrical			
Frequency (MHz)	698-960	1710-2170	2400-2700
Insertion Loss (dB)	≤0.5		
Ripple (dB)	≥0.3		
Isolation (dB)	≥80		
Return Loss/VSWR	≤19dB/1.22		
PIM, 3rd Order (dBc)	≤ -140 (2 x 43 dBm carrier)		
Average power, maximum (W)	200		
Impedance (Ω)	50		

Mechanical	
Operating temperature	-20°C to +65°C
Storage temperature	-40°C to +85°C
Relative humidity	5% - 95%
Classification of waterproof	Indoor
Dimensions (H x W x D) (mm)	148x120x35.5mm
Net weight (with installation kit) (kg)	≤0.9
Connector	N-Female

Schematic Diagram

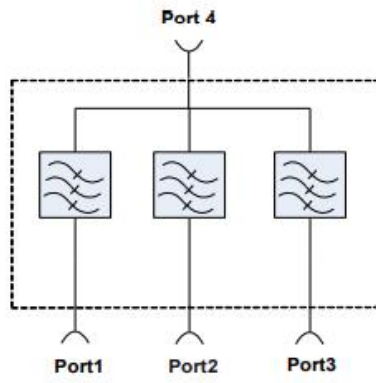

Outline Drawing:

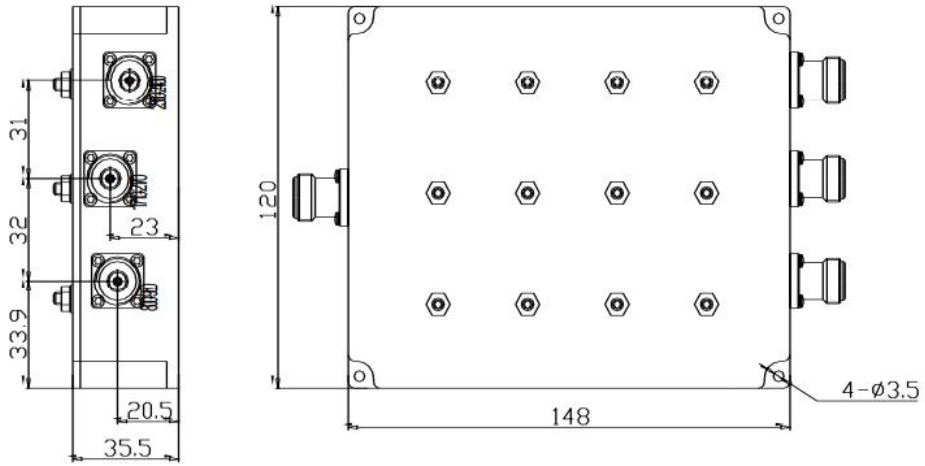

Indoor Triplexer Combiner (800-2170)

Model: PVL101.03010821

Product Features:

- Low Intermodulation
- High Isolation, Low VSWR and Loss
- Low Weight
- High Reliability



Technical Specifications:

Electrical			
Frequency (MHz)	800-960	1710-1880	1920-2170
Insertion Loss (dB)	≤0.6		
Ripple (dB)	≥0.4		
Isolation (dB)	≥80		
Return Loss/VSWR	≤20dB/1.22		
PIM, 3rd Order (dBc)	≤ -140 (2 x 43 dBm carrier)		
Average power, maximum (W)	200		
Impedance (Ω)	50		

Mechanical	
Operating temperature	-20°C to +65°C
Storage temperature	-40°C to +85°C
Relative humidity	5% - 95%
Classification of waterproof	Indoor
Dimensions (H x W x D) (mm)	119x104x28mm
Net weight (with installation kit) (kg)	≤1.3
Connector	N-Female

Schematic Diagram

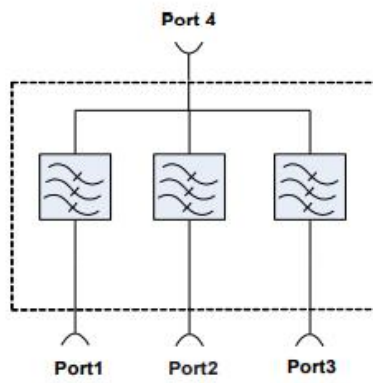

Outline Drawing:

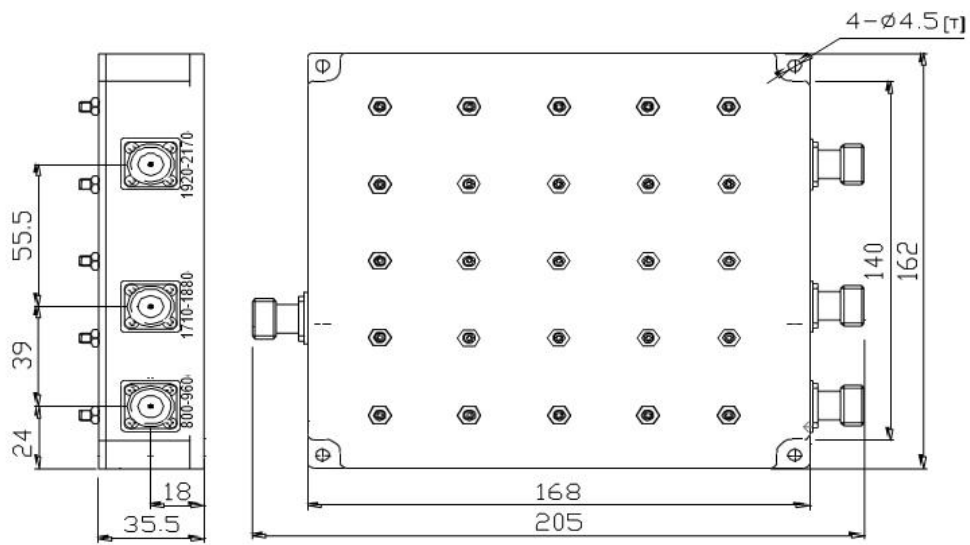

Indoor Quadplexer Combiner (698-2400)

Model: PVL101.04010624

Product Features:

- Low Intermodulation
- High Isolation, Low VSWR and Loss
- Low Weight
- High Reliability



Technical Specifications:

Electrical				
Frequency (MHz)	698-960	1710-1880	1920-2170	2300-2400
Insertion Loss (dB)	≤0.8			
Ripple (dB)	≥0.5			
Isolation (dB)	≥80			
Return Loss/VSWR	≤20dB/1.22			
PIM, 3rd Order (dBc)	≤ -150 (2 x 43 dBm carrier)			
Average power, maximum (W)	200			
Impedance (Ω)	50			

Mechanical	
Operating temperature	-20°C to +65°C
Storage temperature	-40°C to +85°C
Relative humidity	5% - 95%
Classification of waterproof	Indoor
Dimensions (H x W x D) (mm)	175x148x35.5mm
Net weight (with installation kit) (kg)	≤1.45
Connector	N-Female

Schematic Diagram

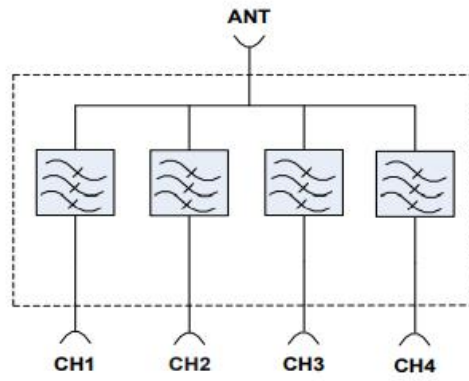

Outline Drawing:

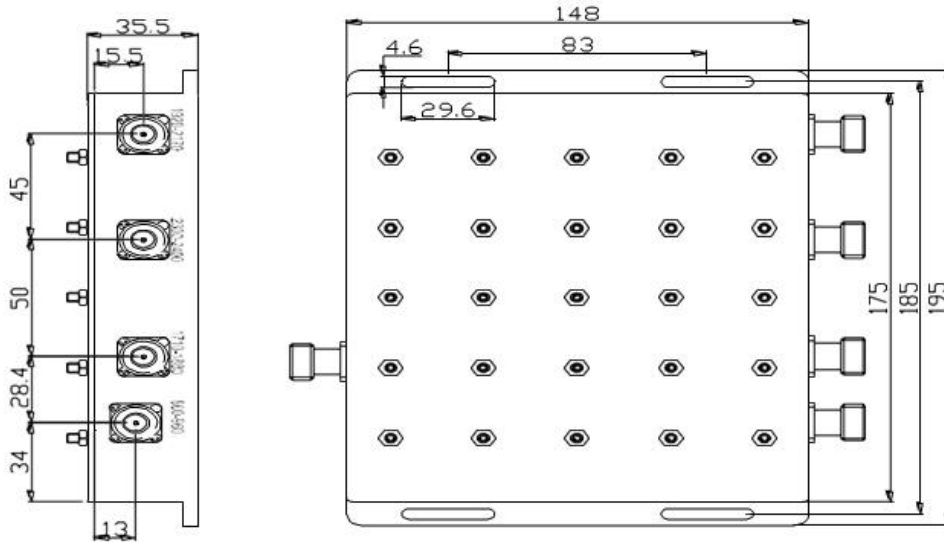

17in 4out POI (Point of Interface) (703-2690)

Model: PVL107.17040726

Product Features:

- Low PIM
- High isolation
- Low VSWR and loss
- High reliability



Technical Specifications:

Electrical	
3 Ports LTE700	703-748MHz/758-803MHz
3 Ports LTE900	885-915MHz/930-960MHz
3 Ports LTE1800	1710-1785MHz/1805-1880MHz
4 Port WCDMA2100	1920-1980MHz/2110-2170MHz
1 Port LTE2600 FDD	2500-2520MHz/2620-2640MHz
1 Port LTE2600 FDD	2520-2540MHz/2640-2660MHz 2560-2570MHz/2680-2690MHz
1 Port LTE2600 FDD	2540-2560MHz/2660-2680MHz
1 Port LTE2600 TDD	2575-2615MHz
Insert loss (dB)	≤8.5 dB for LTE703MHz~WCDMA 2170MHz ≤10.5 dB for LTE2600MHz
Isolation (dB)	Same band ≥25 dB, Different bands≥80dB, FDD/TDD≥110dB
Return Loss	≤18dB
PIM, 3rd Order (dBc)	≤ -150 (2 x 43 dBm carrier)
Monitoring port	-40~-30dBc
Average power, maximum (W)	150
Impedance (Ω)	50
Lightning protection	10KA; 10/350μs pulse

Mechanical	
Operating temperature	+10°C to +55°C
Storage temperature	0°C to +65°C
Relative humidity	5% - 95%
Classification of waterproof	Indoor, 19" rackable
Dimensions (H x W x D) (mm)	482.6x324x352mm
Net weight (without connectors) (kg)	≤40
Connector	Din-Female

Outline Drawing:

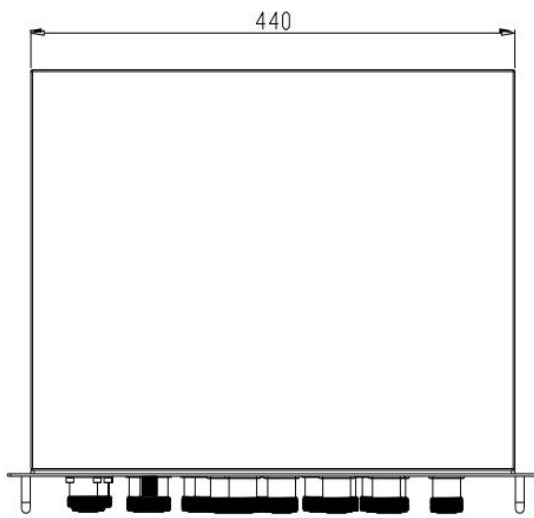
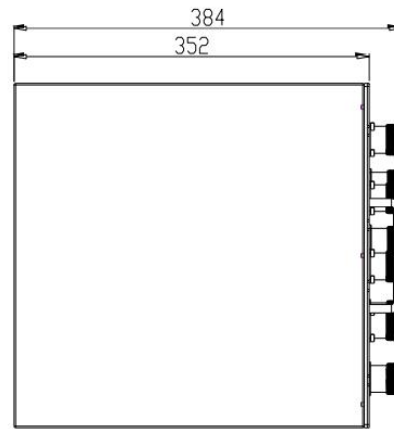
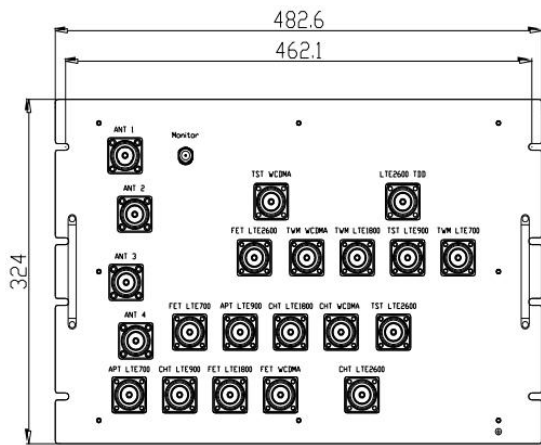

Power Splitter 2-way (555-3800)

Model: PVL102.01020538

Product Features:

- Low insert loss
- Low PIM
- High reliability



Technical Specifications:

Electrical	
Frequency (MHz)	555-3800
VSWR	≤1.25
Split loss (dB)	≤3.2
Insert loss (dB)	≤0.1
Ripple in band (dB)	≤0.3
PIM, 3rd Order (dBc)	≤ -160 (2 x 43 dBm carrier)
Average power, maximum (W)	300
Impedance (Ω)	50

Mechanical	
Operating temperature	-30°C to +75°C
Storage temperature	-45°C to +85°C
Relative humidity	5% - 95%
Classification of waterproof	IP67
Dimensions (H x W x D) (mm)	211x26x26mm
Net weight (with installation kit) (kg)	≤1.5
Connector	N-Female/Din-Female/4.3-10 Female

Schematic Diagram

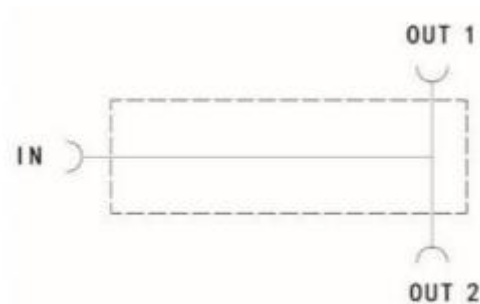

Outline Drawing:

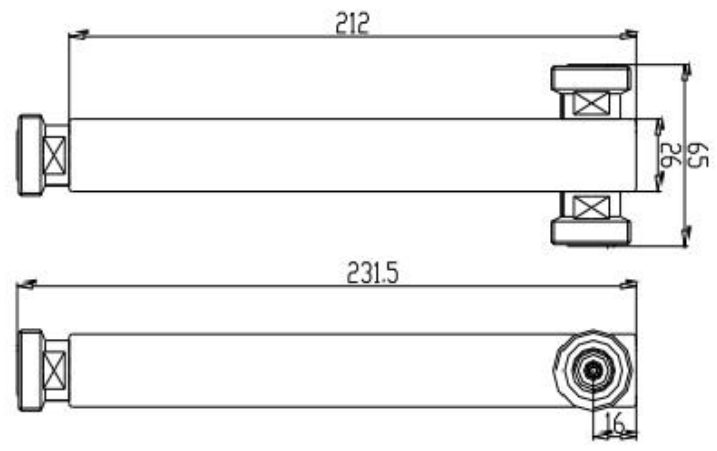

Power Splitter 2-way (698-2700)

Model: PVL102.01020627

Product Features:

- Low insert loss
- Low PIM
- High reliability



Technical Specifications:

Electrical	
Frequency (MHz)	698-2700
VSWR	≤ 1.25
Split loss (dB)	≤ 3.2
Insert loss (dB)	≤ 0.05
Ripple in band (dB)	≤ 0.3
PIM, 3rd Order (dBc)	≤ -160 (2 x 43 dBm carrier)
Average power, maximum (W)	500
Impedance (Ω)	50

Mechanical	
Operating temperature	-30°C to +75°C
Storage temperature	-45°C to +85°C
Relative humidity	5% - 95%
Classification of waterproof	IP67
Dimensions (H x W x D) (mm)	204.7x33x33mm
Net weight (with installation kit) (kg)	≤ 1.5
Connector	N-Female/Din-Female/4.3-10 Female

Schematic Diagram

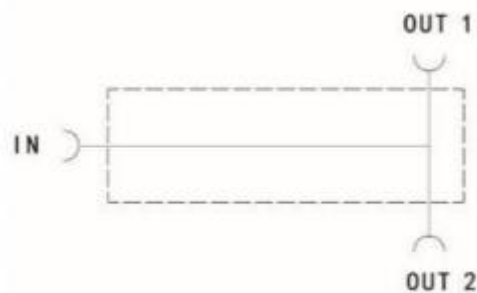

Outline Drawing:

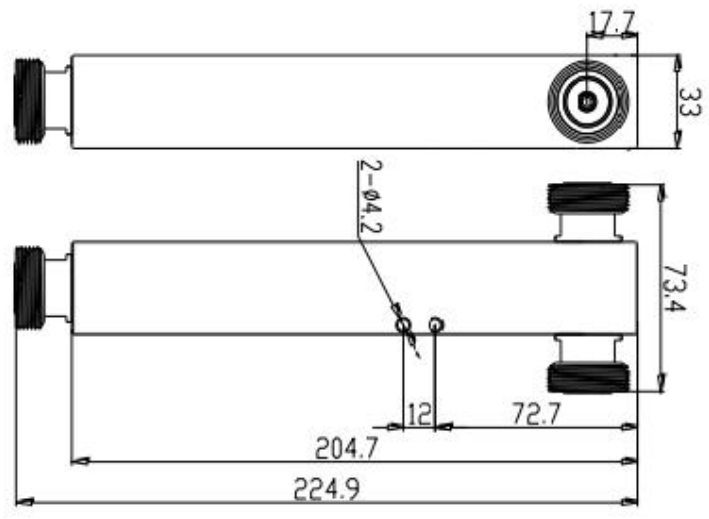

Power Splitter 3-way (555-3800)

Model: PVL102.01030538

Product Features:

- Low insert loss
- Low PIM
- High reliability



Technical Specifications:

Electrical	
Frequency (MHz)	555-3800
VSWR	≤1.25
Split loss (dB)	≤5.2
Insert loss (dB)	≤0.1
Ripple in band (dB)	≤0.4
PIM, 3rd Order (dBc)	≤ -160 (2 x 43 dBm carrier)
Average power, maximum (W)	300
Impedance (Ω)	50

Mechanical	
Operating temperature	-30°C to +75°C
Storage temperature	-40°C to +85°C
Relative humidity	5% - 95%
Classification of waterproof	IP67
Dimensions (H x W x D) (mm)	217x26x26mm
Net weight (with installation kit) (kg)	≤0.55
Connector	N-Female/Din-Female/4.3-10 Female

Schematic Diagram

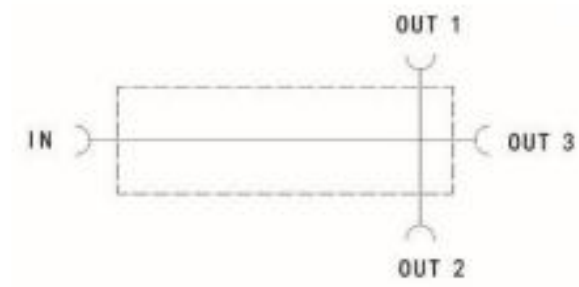

Outline Drawing:

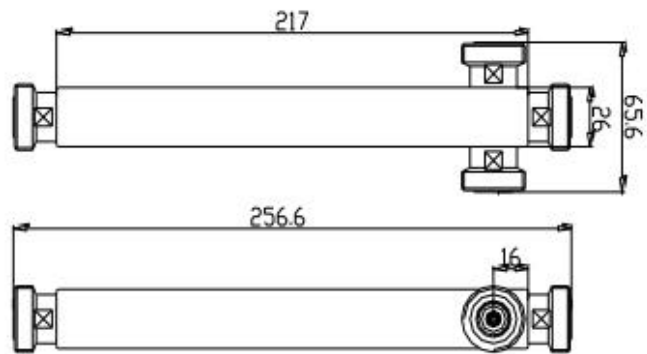

Power Splitter 3-way (698-2700)

Model: PVL102.01030627

Product Features:

- Low insert loss
- Low PIM
- High reliability



Technical Specifications:

Electrical	
Frequency (MHz)	698-2700
VSWR	≤1.25
Split loss (dB)	≤5.2
Insert loss (dB)	≤0.05
Ripple in band (dB)	≤0.4
PIM, 3rd Order (dBc)	≤ -160 (2 x 43 dBm carrier)
Average power, maximum (W)	500
Impedance (Ω)	50

Mechanical	
Operating temperature	-30°C to +75°C
Storage temperature	-40°C to +85°C
Relative humidity	5% - 95%
Classification of waterproof	IP67
Dimensions (H x W x D) (mm)	206.5x33x33mm
Net weight (with installation kit) (kg)	≤1.8
Connector	N-Female/Din-Female/4.3-10 Female

Schematic Diagram

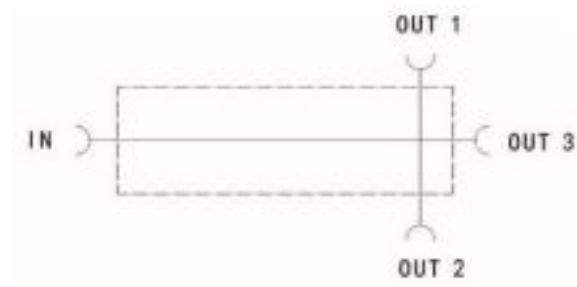

Outline Drawing:

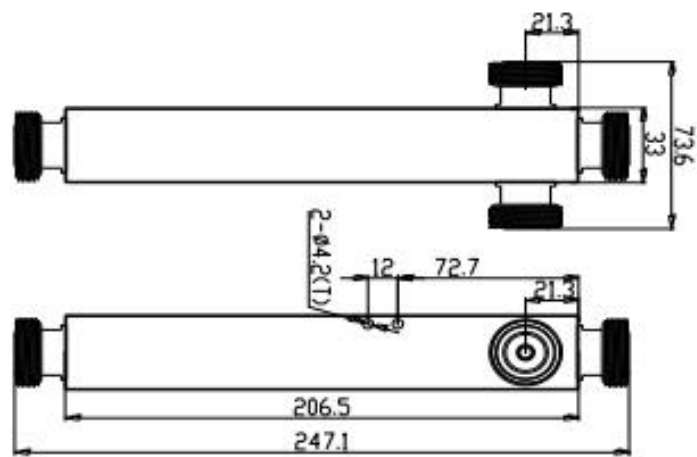

Power Splitter 4-way (555-3800)

Model: PVL102.01040538

Product Features:

- Low insert loss
- Low PIM
- High reliability



Technical Specifications:

Electrical	
Frequency (MHz)	555-3800
VSWR	≤1.25
Split loss (dB)	≤6.4
Insert loss (dB)	≤0.1
Ripple in band (dB)	≤0.5
PIM, 3rd Order (dBc)	≤ -160 (2 x 43 dBm carrier)
Average power, maximum (W)	300
Impedance (Ω)	50

Mechanical	
Operating temperature	-30°C to +75°C
Storage temperature	-40°C to +85°C
Relative humidity	5% - 95%
Classification of waterproof	IP67
Dimensions (H x W x D) (mm)	217x26x26mm
Net weight (with installation kit) (kg)	≤0.65
Connector	N-Female/Din-Female/4.3-10 Female

Schematic Diagram

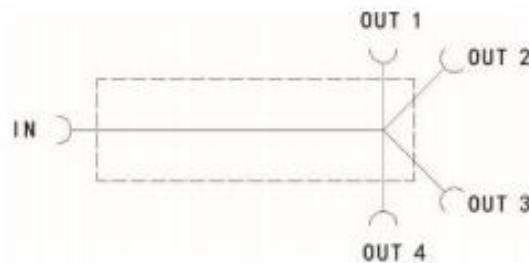

Outline Drawing:

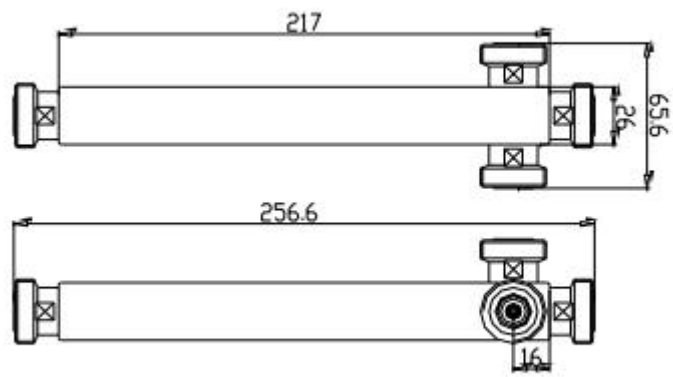

Power Splitter 4-way (698-2700)

Model: PVL102.01040627

Product Features:

- Low insert loss
- Low PIM
- High reliability



Technical Specifications:

Electrical	
Frequency (MHz)	698-2700
VSWR	≤1.25
Split loss (dB)	≤6.4
Insert loss (dB)	≤0.05
Ripple in band (dB)	≤0.5
PIM, 3rd Order (dBc)	≤ -160 (2 x 43 dBm carrier)
Average power, maximum (W)	500
Impedance (Ω)	50

Mechanical	
Operating temperature	-30°C to +75°C
Storage temperature	-40°C to +85°C
Relative humidity	5% - 95%
Classification of waterproof	IP67
Dimensions (H x W x D) (mm)	235.5x33x33mm
Net weight (with installation kit) (kg)	≤2.1
Connector	N-Female/Din-Female/4.3-10 Female

Schematic Diagram

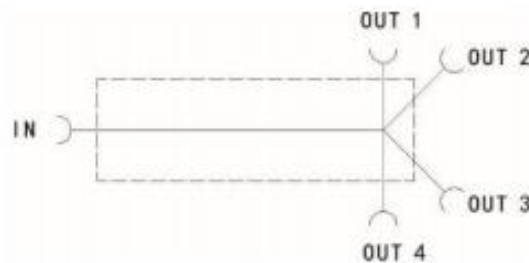

Outline Drawing:

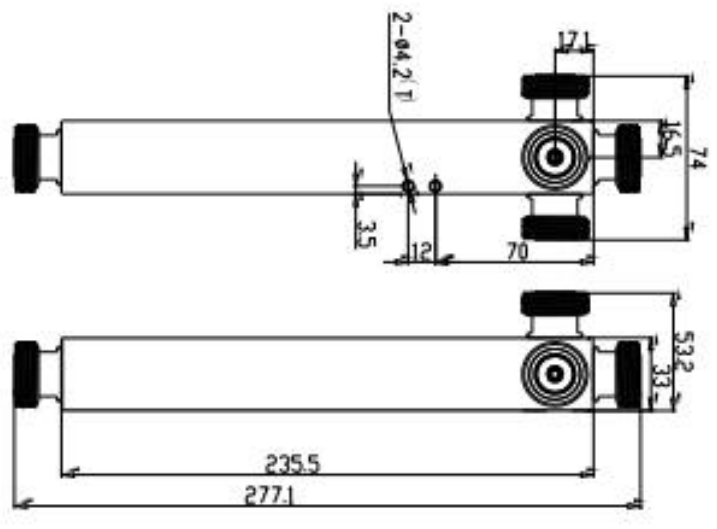

Power Splitter 8-way (698-2700)

Model: PVL102.01080627

Product Features:

- Low insert loss
- Low PIM
- High reliability

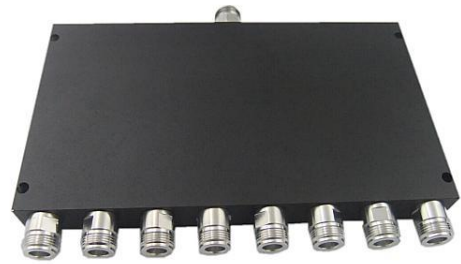

Technical Specifications:

Electrical	
Frequency (MHz)	698-2700
VSWR	≤1.25
Split loss (dB)	≤9.0
Insert loss (dB)	≤1.2
Ripple in band (dB)	≤0.5
PIM, 3rd Order (dBc)	≤ -160 (2 x 43 dBm carrier)
Average power, maximum (W)	50
Impedance (Ω)	50

Mechanical	
Operating temperature	-30°C to +75°C
Storage temperature	-40°C to +85°C
Relative humidity	5% - 95%
Classification of waterproof	IP65
Dimensions (H x W x D) (mm)	235.5x33x33mm
Net weight (with installation kit) (kg)	≤2.1
Connector	N-Female/Din-Female/4.3-10 Female

Power Tapper (698-6000)

Model: PVL108.300660

Product Features:

- 5G compatible
- Low insert loss
- Low PIM
- High reliability



Technical Specifications:

Electrical							
Frequency (MHz)	698-960/1700-2700/2700-6000						
Coupling level	3	6	10	13	15	20	30
Coupling value (dB)	4.8±0.8	7.0±0.8	10.4±1.0	13.2±1.25	15.1±1.25	20.1±1.5	30.1±2
Insert loss (dB)	≤3.1	≤2.0	≤1.2	≤1.0	≤0.8	≤0.5	≤0.4
VSWR	≤1.3@698-960MHz&1700-2700; ≤1.5@2700-6000MHz						
PIM, 3rd Order (dBc)	≤ -161 (2 x 43 dBm carrier)						
Average power, maximum (W)	200						
Impedance (Ω)	50						

Mechanical	
Operating temperature	-20°C to +60°C
Storage temperature	-35°C to +75°C
Relative humidity	5% - 95%
Classification of waterproof	IP67
Dimensions (H x W x D) (mm)	105x25x25mm
Net weight (kg)	≤0.50
Connector	N-Female/Din-Female/4.3-10 Female

Power Tapper (698-3800)

Model: PVL108.300638

Product Features:

- 5G compatible
- Low insert loss
- Low PIM
- High reliability



Technical Specifications:

Electrical							
Frequency (MHz)	698-3800						
Coupling level	3	6	10	13	15	20	30
Coupling value (dB)	4.8±0.8	7.0±0.8	10.4±1.0	13.2±1.25	15.1±1.25	20.1±1.5	30.1±2
Insert loss (dB)	≤3.1	≤2.0	≤1.2	≤1.0	≤0.8	≤0.5	≤0.4
VSWR	≤1.3						
PIM, 3rd Order (dBc)	≤ -160 (2 x 43 dBm carrier)						
Average power, maximum (W)	200						
Impedance (Ω)	50						

Mechanical	
Operating temperature	-20°C to +60°C
Storage temperature	-35°C to +75°C
Relative humidity	5% - 95%
Classification of waterproof	IP67
Dimensions (H x W x D) (mm)	105x25x25mm
Net weight (kg)	≤0.50
Connector	N-Female/Din-Female/4.3-10 Female

Power Tapper (400-2700)

Model: PVL108.300427

Product Features:

- Low insert loss
- Low PIM
- High reliability



Technical Specifications:

Electrical							
Frequency (MHz)	400-960/1710-2700						
Coupling level	3	6	10	13	15	20	30
Coupling value (dB)	4.8±0.8	7.0±0.8	10.4±1.0	13.2±1.25	15.1±1.25	20.1±1.5	30.1±1.3
Insert loss (dB)	≤3.1	≤2.0	≤1.2	≤1.0	≤0.8	≤0.5	≤0.4
VSWR	≤1.3						
PIM, 3rd Order (dBc)	≤ -163 (2 x 43 dBm carrier)						
Average power, maximum (W)	500						
Impedance (Ω)	50						

Mechanical	
Operating temperature	-20°C to +60°C
Storage temperature	-35°C to +75°C
Relative humidity	5% - 95%
Classification of waterproof	IP66
Dimensions (H x W x D) (mm)	138x46x25mm
Net weight (kg)	≤0.50
Connector	N-Female/Din-Female/4.3-10 Female



1. The first part of the document discusses the importance of data security in the modern business environment. It highlights the risks associated with data breaches and the need for robust security measures to protect sensitive information.

2. The second part of the document focuses on the implementation of security protocols. It provides a detailed overview of the various security measures that can be implemented, including firewalls, intrusion detection systems, and data encryption.

3. The third part of the document addresses the human element of security. It emphasizes the role of employees in maintaining security and provides guidelines for creating a security-aware culture within the organization.

4. The final part of the document discusses the importance of regular security audits and updates. It explains how these practices can help identify vulnerabilities and ensure that security measures remain effective over time.